



RMA7 LCD

FEATURE

- ☐ Adopting 7-inch LCD screen with resolution of 1024*600
- ☐ Graphical menu design, rich display content
- ☐ Supporting adjustable screen brightness and backlight time, with one-key screen off function
- ☐ With dark color mode, comfortable and easy to read.
- ☐ Supports cascading applications with multiple RMA4 screens
- ☐ Support to control the switch of CU4 and DB12
- ☐ Supports customization of frequently used keys
- ☐ Industrial grade design, strong anti-interference

ABOUT SRNE

- ☐ SRNE 15 years in PV industry, committed to independent R&D and production.
- ☐ Holds over 200 patents in energy storage, with unique industry-leading technologies.
- ☐ Chooses top-quality international components to deliver high-value products to customers.
- ☐ Upholds values of customer priority, proactivity, responsibility, and innovative breakthroughs.

MAIN

MODEL	SR-RMA7
Operating Current	< 600mA
Sleep mode power consumption	< 150mA
communication method	RS485
baud	115200bps
Adapted products	CU2/CU4
Maximum number of cascades	Cascadable to up to 6 RMA4 LCDs
operating temperature	-20~70°C
Installation	Panel mount or wall mount
protection class	IP20
screen size	7inch
Packaging	Kraft case (screen, 5m network cable, PE bag, manual, pearl cotton)

FUNCTION

Supports control of CU4 switches or control of DB12 switches

1.When connecting to CU4, it supports displaying real-time information such as inverter, coulometer, controller, fault, etc.; clock display and setting; temperature and liquid level setting.

2.When connecting DB12, you can view the two input voltages, currents, power, switch fault status, and input fault status.

MOUNTING DIMENSIONS

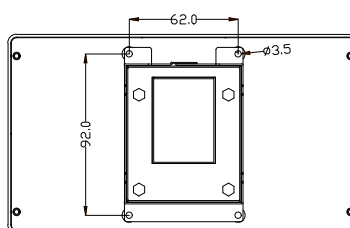

RECESSED OPENING SIZE

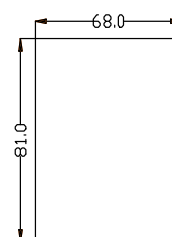

CONNECTION DIAGRAM

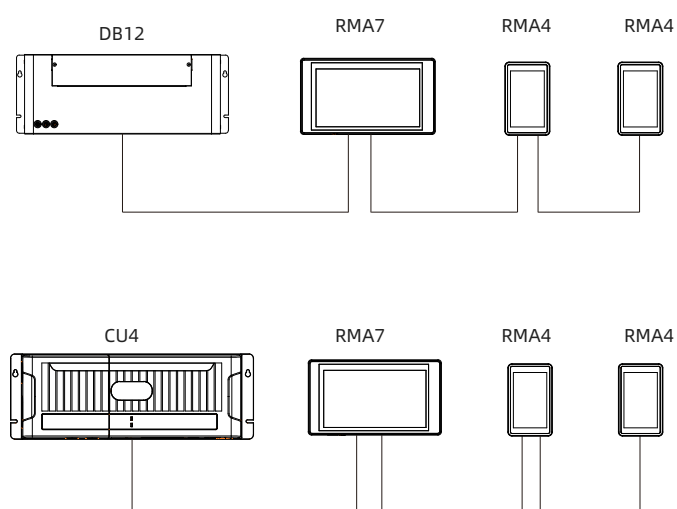

PRODUCT SIZE

